

STRAIGHT MALE MODULES FOR MOTHER CARD (equipped with straight solder P.C.B male coaxial inserts)

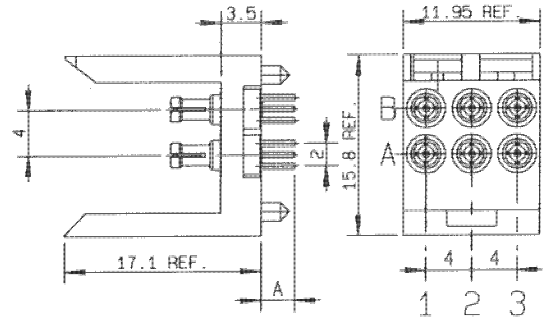
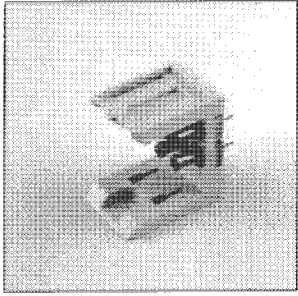

part number	position	Number of contacts	A dimension (mm)	recommended PCB thickness (mm)	P.C.B layout
R694 251 011●		2	2.5	1.6 max	P01
R694 251 012●		2	2.5	1.6 max	P01
R694 251 013●		2	2.5	1.6 max	P01
R694 251 014●		4	2.5	1.6 max	P01
R694 251 015●		4	2.5	1.6 max	P01
R694 251 016●		4	2.5	1.6 max	P01
R694 251 017●		6	2.5	1.6 max	P01
R694 251 021		2	3	2 max	P01
R694 251 022		2	3	2 max	P01
R694 251 023		2	3	2 max	P01
R694 251 024		4	3	2 max	P01
R694 251 025		4	3	2 max	P01
R694 251 026		4	3	2 max	P01
R694 251 027		6	3	2 max	P01

Other arrangements or A dimensions can be developed upon request. Please consult.

● Upon request.